

**TWO HOLE HYLUG™  
CODE CONDUCTOR  
LONG BARREL WITH  
INSPECTION WINDOW**

**TYPES YAZ-2N, YAZ-2TC  
COPPER COMPRESSION  
TERMINAL**

UL Listed 90° C,  
600 Volts to 35 kV ◆

45° and 90° angles are available.  
Please contact Customer Service to order:  
1-800-346-4175

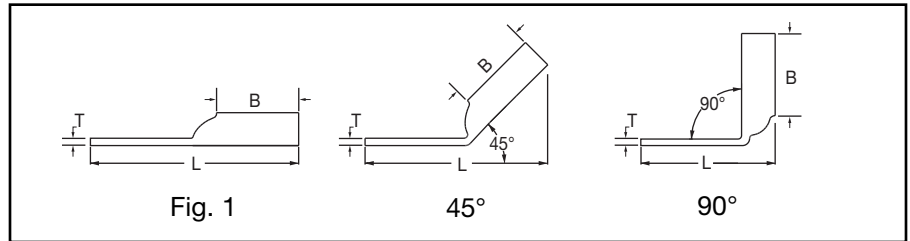
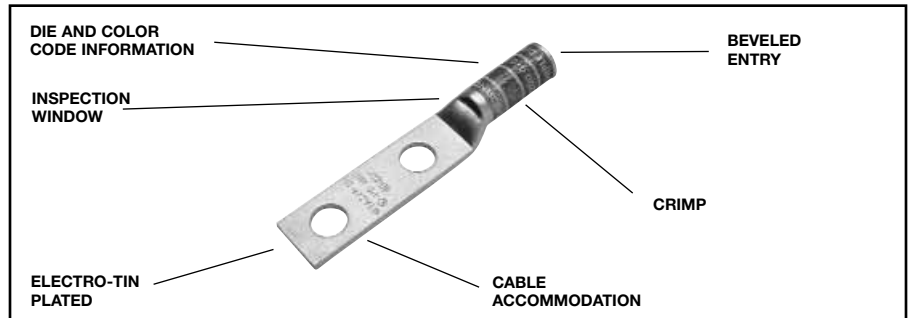

Catalog Number	Fig #	Conductor		Stud Hole Size	Stud Hole Spacing	Tongue Width	Figure Dimensions			Dieless (# of crimps)	▲ Installation Tooling					Wire Strip Length
		AWG	MM²				(B)	(T)	(L)		Mechanical MD6, OUR840, MD7-34R	Hydraulic		Color Code	Die Index	
												BCT500HS, Y500GTHS	Y35, Y39, Y750, Y46*, PAT750			
<b>YAZV10-2TC14</b>	1	14-10 AWG	6	1/4"	5/8"	.41"	.69"	.05"	2.16"	Y8MRB-1 (2)	—	—	—	—	—	3/4"
<b>YAZV10-2TC14E2</b>	1			1/4"	3/4"	.41"	.69"	.05"	2.28"							
<b>YAZ8C-2TC10</b>	1	#8 Str #6 Sol 37/24	† 10	#10	5/8"	.41"	.75"	.08"	2.20"	Y1MRTC (2)	W8CVT (2) W8CRT (2) X8CRT (2)	W8CVT (2) W8CRT (2) X8CRT (2)	U8CRT (2)	Red	49	7/8"
<b>YAZ8C-2TC10E2</b>	1			#10	3/4"	.41"	.75"	.08"	2.33"	Y8MRB-1 (2)						
<b>YAZ8C-2TC14</b>	1			1/4"	5/8"	.44"	.75"	.08"	2.33"	MY29-3 (2)						
<b>YAZ8C-2TC14E2</b>	1			1/4"	3/4"	.44"	.75"	.08"	2.45"	MY29-11 (2)						
<b>YAZ8C-2TC14E1</b>	1			1/4"	1"	.44"	.75"	.08"	2.70"	MRC840 (2)						
<b>YAZ8C-2TC38</b>	1			3/8"	1"	.58"	.75"	.06"	2.89"	Y81KFT (1)						
<b>YAZ6C-2N</b>	1	#6 AWG	—	1/2"	1-3/4"	.83"	1.12"	.12"	4.40"	MY29-3 (2)	W5CVT (2) W5CRT (2) X5CRT (2) X8CART (2)	W5CVT (2) X5CRT (2) X8CART (2)	U5CRT (2) U8CABT (2)	Blue	7 or 374	1-1/16"
<b>YAZ6C-2TC10E2</b>	1			#10	3/4"	.42"	1.12"	.09"	2.65"	MY29-11 (2)						
<b>YAZ6C-2TC14</b>	1	#6 AWG	—	1/4"	5/8"	.45"	1.12"	.08"	2.65"	Y1MRTC (2)	W5CVT (2) W5CRT (2) X5CRT (2) X8CART (2)	W5CVT (2) X5CRT (2) X8CART (2)	U5CRT (2) U8CABT (2)	Blue	7 or 374	1-1/16"
<b>YAZ6C-2TC14E2</b>	1			1/4"	3/4"	.45"	1.12"	.08"	2.78"	MY29-3 (2)						
<b>YAZ6C-2TC14E1</b>	1			1/4"	1"	.45"	1.12"	.08"	3.03"	MY29-11 (2)						
<b>YAZ6C-2TC38E2</b>	1			3/8"	3/4"	.58"	1.12"	.06"	2.97"	MRC840 (2)						
<b>YAZ6C-2TC38E6</b>	1			3/8"	7/8"	.58"	1.12"	.06"	3.09"	Y644HS (2)						
<b>YAZ6C-2TC38</b>	1			3/8"	1"	.58"	1.12"	.06"	3.22"	Y81KFT (1)						
<b>YAZ5C-2N</b>	1	#5 AWG	—	1/2"	1-3/4"	.83"	1.12"	.12"	4.43"	Y81KFTMBH (1)	W5CRT (2) W5CVT (2) X5CRT (2)	W5CVT (2) W5CRT (2) X5CRT (2)	U5CRT (2)	Blue	7 or 374	1/16"

▲ See tooling section of this catalog for complete tool and die listings.  
\* Use PUADP-1 adaptor with U -dies in Y46 HYPRESS™.  
\*\* P-RT die sets for use in Y46 HYPRESS™ only, PUADP-1 adaptor not required.

\*\*\* The MM² conductor sizes listed are the recommendations for Class 2 conductor.  
† The MM² conductor size referred to here is for Class 2 and Class 5 conductor.

Available undrilled. Add suffix U to catalog number (example: YA25U).  
◆ For applications greater than 2000 Volts consult cable manufacturer for voltage stress relief instructions.  
**Note:** All dimensions shown are for reference only.

**Blue highlighted items are industry standard and most frequently ordered.**

# Compression Connections

**BURNDY®**

Copper Compression – Code – Long Barrel – Inspection Window

C-40

## TWO HOLE HYLUG™ CODE CONDUCTOR LONG BARREL WITH INSPECTION WINDOW (Continued)

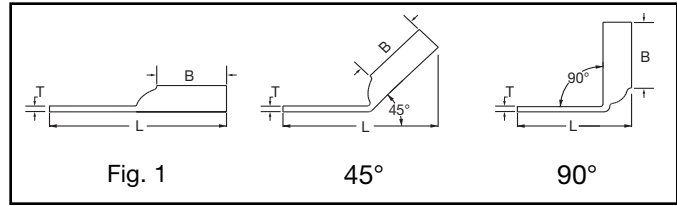

UL Listed 90° C,  
600 Volts to 35 kV ◆

45° and 90° angles are available.  
Please contact Customer Service to order:  
1-800-346-4175



Catalog Number	Fig #	Conductor		Stud Hole Size	Stud Hole Spacing	Tongue Width	Figure Dimensions			Dieless (# of crimps)	▲ Installation Tooling					Wire Strip Length
		AWG	MM <sup>2</sup>				(B)	(T)	(L)		Mechanical MD6, OUR840, MD7-34R	Hydraulic		Color Code	Die Index	
												BCT500HS, Y500CTHS	Y35, Y39, Y750, Y46*, PAT750			
YAZ4C-2N	1	#4 AWG	—	1/2"	1-3/4"	.83"	1.12"	.12"	4.42"	Y1MRTC (4) MY29-3 (2) MY29-11 (2) MRC840 (2) Y644HS (2) Y81KFT (1) PAT81KFT-18V (1)	W4CVT (2) W4CRT (2) X4CRT (2)	W4CVT (2) W4CRT (2) X4CRT (2)	U4CRT (2) U6CABT (2)	Gray	8 or 346	1-1/16"
YAZ4C-2TC10-E2	1			#10	3/4"	.49"	1.12"	.09"	2.67"							
YAZ4C-2TC14	1			1/4"	5/8"	.49"	1.12"	.09"	2.67"							
YAZ4C-2TC14E2	1			1/4"	3/4"	.49"	1.12"	.09"	2.80"							
YAZ4C-2TC38	1			3/8"	1"	.58"	1.12"	.08"	3.01"							
YAZ3C-2N	1	#3 AWG #2 Sol	25	1/2"	1-3/4"	.83"	1.25"	.12"	4.58"	Y1MRTC (4) MY29-3 (2) MY29-11 (2) MRC840 (2) Y644HS (2) Y81KFT (2) Y81KFTMBH (2) PAT81KFT-18V (2)	W3CRT (2)	W3CRT (2)	U3CRT (2)	White	9	1-5/16"
YAZ3C-2TC14	1			1/4"	5/8"	.55"	1.25"	.09"	2.83"							
YAZ3C-2TC14E2	1			1/4"	3/4"	.55"	1.25"	.09"	2.95"							
YAZ3C-2TC38E2	1			3/8"	3/4"	.58"	1.25"	.08"	3.14"							
YAZ3C-2TC38	1	#3 AWG #2 Sol	25	3/8"	1"	.58"	1.25"	.08"	3.39"		W3CRT (2)	W3CRT (2)	U3CRT (2)	White	9	1-5/16"
YAZ2C-2N	1	#2 AWG	35	1/2"	1-3/4"	.83"	1.25"	.12"	4.60"	Y1MRTC (4) MY29-3 (2) MY29-11 (2) MRC840 (2) Y644HS (1) Y81KFT (2) Y81KFTMBH (2) PAT81KFT-18V (2)	W2CVT (2) W2CRT (2) X2CRT (2)	W2CVT (2) W2CRT (2) X2CRT (2)	U2CRT (2)	Brown	10	1-5/16"
YAZ2C-2TC10E2	1			#10	3/4"	.60"	1.25"	.11"	2.85"							
YAZ2C-2TC14	1			1/4"	5/8"	.60"	1.25"	.11"	2.85"							
YAZ2C-2TC14E2	1			1/4"	3/4"	.60"	1.25"	.11"	2.97"							
YAZ2C-2TC14E1	1			1/4"	1"	.60"	1.25"	.11"	3.22"							
YAZ2C-2TC516E2	1			5/16"	3/4"	.60"	1.25"	.11"	3.03"							
YAZ2C-2TC38E2	1			3/8"	3/4"	.60"	1.25"	.11"	3.16"							
YAZ2C-2TC38E6	1			3/8"	7/8"	.60"	1.25"	.11"	3.28"							
YAZ2C-2TC38	1			3/8"	1"	.60"	1.25"	.11"	3.41"							
YAZ2C-2NTC38	1			3/8"	1-3/4"	.60"	1.25"	.11"	4.16"							
YAZ1C-2N	1	#1 AWG	50	1/2"	1-3/4"	.83"	1.38"	.12"	4.76"	W1CVT (2) W1CRT-1 (2) X1CRT-1 (2)	W1CVT (2) W1CRT-1 (2) X1CRT-1 (2)	U1CRT-1 (2) U4CABT (2)	Green	11 or 375	1-7/16"	
YAZ1C-2TC14	1			1/4"	5/8"	.67"	1.38"	.10"	3.01"							
YAZ1C-2TC14E2	1			1/4"	3/4"	.67"	1.38"	.10"	3.13"							
YAZ1C-2TC38	1			3/8"	1"	.67"	1.38"	.10"	3.57"							
YAZ25-2N	1	1/0 AWG	—	1/2"	1-3/4"	.83"	1.38"	.11"	4.79"	MY29-3 (2) MY29-11 (2) MRC840 (4) Y644HS (1) Y81KFT (2) Y81KFTMBH (2) PAT81KFT-18V (2)	W25RT (4) W25VT (4) X25RT (4)	W25VT (4) W25RT (4) W25RT (4)	U25RT (2) U2CABT (2)	Pink	12 or 348	1-7/16"
YAZ25-2TC14	1			1/4"	5/8"	.75"	1.38"	.12"	3.04"							
YAZ25-2TC14E2	1			1/4"	3/4"	.75"	1.38"	.12"	3.16"							
YAZ25-2TC14E1	1			1/4"	1"	.75"	1.38"	.12"	3.41"							
YAZ25-2TC516E6	1			5/16"	7/8"	.75"	1.38"	.12"	3.35"							
YAZ25-2TC516	1			5/16"	1"	.75"	1.38"	.12"	3.47"							
YAZ25-2TC38	1			3/8"	1"	.75"	1.38"	.12"	3.60"							
YAZ25-2NTC38	1			3/8"	1-3/4"	.75"	1.38"	.12"	4.35"							

▲ See tooling section of this catalog for complete tool and die listings.  
\* Use PUADP-1 adaptor with U -dies in Y46 HYPRESS™.  
\*\* P-RT die sets for use in Y46 HYPRESS™ only, PUADP-1 adaptor not required.

\*\*\* The MM<sup>2</sup> conductor sizes listed are the recommendations for Class 2 conductor.  
Available undrilled. Add suffix U to catalog number (example: YA25U).

◆ For applications greater than 2000 Volts consult cable manufacturer for voltage stress relief instructions.  
**Note:** All dimensions shown are for reference only.

Blue highlighted items are industry standard and most frequently ordered.

**TWO HOLE HYLUG™  
CODE CONDUCTOR  
LONG BARREL WITH  
INSPECTION WINDOW  
(Continued)**

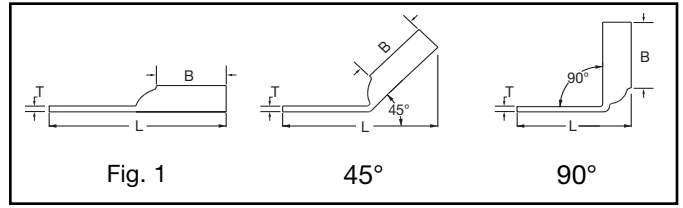

UL Listed 90° C,  
600 Volts to 35 kV ◆



45° and 90° angles are available.  
Please contact Customer Service to order:  
1-800-346-4175

Catalog Number	Fig #	Conductor		Stud Hole Size	Stud Hole Spacing	Tongue Width	Figure Dimensions			Dieless (# of crimps)	▲ Installation Tooling				Wire Strip Length	
		AWG	*** MM <sup>2</sup>				(B)	(T)	(L)		Mechanical MD6, OUR840, MD7-34R	Hydraulic		Color Code		Die Index
												BCT500HS, Y500CTS	Y35, Y39, Y750, Y46*, PAT750			
YAZ26-2N	1	2/0 AWG	70	1/2"	1-3/4"	.83"	1.50"	.12"	4.95"	MY29-3 (2) MY29-11 (2)	W26VT (4) W26RT (4) X26RT (4)	W26VT (4) W26RT (4) X26RT (4)	U26RT (2)	Black	13	1-9/16"
YAZ26-2TC14	1			1/4"	5/8"	.83"	1.50"	.12"	3.20"							
YAZ26-2TC14E2	1			1/4"	3/4"	.83"	1.50"	.12"	3.32"							
YAZ26-2TC38	1			3/8"	1"	.83"	1.50"	.12"	3.76"							
YAZ27-2N	1	3/0 AWG	—	1/2"	1-3/4"	.91"	1.50"	.13"	4.98"	MRC840 (4) Y644HS (1) Y81KFT (2)	W27VT (4) W27RT (4) X27RT (6)	W27VT (4) W27RT (4) X27RT (6)	U27RT (2)	Orange	14	1-9/16"
YAZ27-2TC14E2	1			1/4"	3/4"	.90"	1.50"	.12"	3.36"							
YAZ27-2TC38	1			3/8"	1"	.90"	1.50"	.12"	3.80"							
YAZ28-2N	1	4/0 AWG	—	1/2"	1-3/4"	1.02"	1.62"	.14"	5.15"	Y81KFTMBH (2) PAT81KFT-18V (2)	W28VT (4) W28RT (4) X28RT (6)	W28VT (4) W28RT (4) X28RT (6)	U28RT (2)	Purple	15	1-11/16"
YAZ28-2TC14E2	1			1/4"	3/4"	1.02"	1.62"	.14"	3.55"							
YAZ28-2TC38	1			3/8"	1"	1.02"	1.62"	.14"	3.99"							
YAZ28-2NTC38	1			3/8"	1-3/4"	1.02"	1.62"	.14"	4.74"							
YAZ29-2N	1	250 kcmil	—	1/2"	1-3/4"	1.10"	1.62"	.16"	5.18"	MY29-3 (2) MY29-11(2) Y644HS (1) Y81KFT (2) Y81KFTMBH (2) PAT81KFT-18V (2)	W29VT (4) X29RT (8)	X29RT (8) W29VT (4) W29RT (4)	U29RT (2)	Yellow	16	1-11/16"
YAZ29-2TC38	1			3/8"	1"	1.10"	1.62"	.14"	3.99"							
YAZ30-2N	1	300 kcmil	150	1/2"	1-3/4"	1.20"	2.00"	.16"	5.60"	Y644HS (1) Y81KFT (3) Y81KFTMBH (3) PAT81KFT-18V (3)	W30VT (4)	W30VT (4) W30RT (4)	U30RT (4) U28ART (4)	White	17 or 298	2-1/16"
YAZ30-2TC38	1			3/8"	1"	1.20"	2.00"	.16"	4.42"							
YAZ31-2N	1	350 kcmil	185	1/2"	1-3/4"	1.29"	2.00"	.18"	5.64"	Y81KFTMBH (3) PAT81KFT-18V (3)	W31VT (4)	W31VT (4) W31RT (4)	U31RT (4) U29ART (4)	Red	18 or 324	2-1/16"
YAZ31-2TC14E2	1			1/4"	3/4"	1.29"	2.00"	.18"	4.02"							
YAZ31-2TC38	1			3/8"	1"	1.29"	2.00"	.18"	4.45"							
YAZ32-2N	1	400 kcmil	—	1/2"	1-3/4"	1.40"	2.12"	.19"	5.81"	Y81KFTMBH (4) PAT81KFT-18V (4)	W32VT (4)	W32VT (4) W32RT (4)	U32RT (4) U30ART (4)	Blue	19 or 470	2-1/16"
YAZ32-2TC38	1			3/8"	1"	1.40"	2.12"	.19"	4.62"							
YAZ33-2N	1	450 kcmil	—	1/2"	1-3/4"	1.48"	2.13"	.21"	5.89"	Y644HS (1) Y81KFT (4)	W33VT (4)	W33VT (4) W33RT (4)	U33RT (4)	Gray	326 or 538	2-5/16"
YAZ34-2N	1	500 kcmil	240	1/2"	1-3/4"	1.55"	2.25"	.23"	6.04"							
YAZ34-2TC14E2	1			1/4"	3/4"	1.55"	2.25"	.23"	4.42"							
YAZ34-2TC38	1			3/8"	1"	1.55"	2.25"	.23"	4.85"							
YAZ35-2N	1	550 kcmil	—	1/2"	1-3/4"	1.65"	2.63"	.25"	6.45"	Y81KFTMBH (4) PAT81KFT-18V (4)	—	—	U35RT (4)	Yellow	21	2-11/16"
YAZ36-2N	1	600 kcmil	300	1/2"	1-3/4"	1.74"	2.69"	.27"	6.55"							
YAZ36-2TC38	1			3/8"	1"	1.74"	2.69"	.26"	5.55"							
YAZ37-2N	1			650 kcmil	—	1/2"	1-3/4"	1.80"	2.81"	.27"	6.70"					
YAZ38-2N	1	700 kcmil	—	1/2"	1-3/4"	1.84"	2.81"	.27"	6.72"	—	—	U38RT (4)	Pink	400	2-7/8"	

▲ See tooling section of this catalog for complete tool and die listings.  
\* Use PUADP-1 adaptor with U -dies in Y46 HYPRESS™.  
\*\* P-RT die sets for use in Y46 HYPRESS™ only, PUADP-1 adaptor not required.

\*\*\* The MM<sup>2</sup> conductor sizes listed are the recommendations for Class 2 conductor. Available undrilled. Add suffix U to catalog number (example: YA25U).

◆ For applications greater than 2000 Volts consult cable manufacturer for voltage stress relief instructions.  
**Note:** All dimensions shown are for reference only.

**Blue highlighted items are industry standard and most frequently ordered.**

# Compression Connections

**BURNDY®**

Copper Compression – Code – Long Barrel – Inspection Window

C-42

## TWO HOLE HYLUG™ CODE CONDUCTOR LONG BARREL WITH INSPECTION WINDOW (Continued)

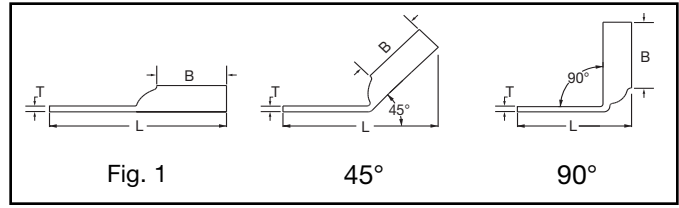

UL Listed 90° C,  
600 Volts to 35 kV ◆



45° and 90° angles are available.

Please contact Customer Service to order:  
1-800-346-4175

Catalog Number	Fig #	Conductor		Stud Hole Size	Stud Hole Spacing	Tongue Width	Figure Dimensions			▲ Installation Tooling												
		AWG	MM <sup>2</sup>				(B)	(T)	(L)	Dieless (# of crimps)	Mechanical		Hydraulic		Color Code	Die Index	Wire Strip Length					
											MD6, OUR840, MD7-34R	BCT500HS, Y500CTS	Y35, Y39, Y750, Y46*, PAT750	Y46*								
YAZ39-2N	1	750 kcmil	—	1/2"	1-3/4"	1.91"	2.88"	.27"	6.82"	Y644HS (1) Y81KFT (4) Y81KFTMBH (4) PAT81KFT-18V (4)	—	—	U39RT (4) P39RT (4) **	Black	24	2-15/16"						
YAZ39-2NT38	1			3/8"	1"	1.63"	2.88"	.27"	5.82"													
YAZ39-2TC38	1			3/8"	1"	1.91"	2.88"	.27"	5.82"													
YAZ39-2NNT	1			1/2"	1-3/4"	1.63"	2.88"	.27"	6.82"													
YAZ40-2N	1	800 kcmil	400	1/2"	1-3/4"	1.98"	2.94"	.30"	6.89"	Y644HS (1) Y81KFT (4) Y81KFTMBH (4) PAT81KFT-18V (4)	—	—	P40RT (4) **	Orange	25	3"						
YAZ41-2N	1	850 kcmil	—	1/2"	1-3/4"	2.01"	2.94"	.31"	6.91"								Gold		3"			
YAZ44-2N	1	1000 kcmil	500	1/2"	1-3/4"	2.19"	3.00"	.33"	7.08"								—	—	P44RT (4) **	White	27	3-1/16"
YAZ44-2TC38	1			3/8"	1"	2.19"	3.00"	.33"	6.09"													
YAZ45-2N	1	1250 kcmil	—	1/2"	1-3/4"	2.46"	3.19"	.38"	7.38"	Y644HS (1) Y81KFT (4) Y81KFTMBH (4) PAT81KFT-18V (4)	—	—	P45RT (6) **	Yellow	29	3-1/4"						
YAZ453-2N	1	1300 kcmil	—	1/2"	1-3/4"	2.53"	3.19"	.39"	7.41"								Orange	30	2-1/16"			
YAZ46-2N	1	1500 kcmil	—	1/2"	1-3/4"	2.69"	3.19"	.40"	7.48"								Green	31	3-5/16"			
YAZ47-2N	1	1750 kcmil	—	1/2"	1-3/4"	2.90"	3.44"	.42"	7.82"								Gray	33	3-1/2"			
YAZ48-2N	1	2000 kcmil	—	1/2"	1-3/4"	3.10"	3.44"	.46"	7.89"	—	—	—	Brown	34	3-1/2"							

▲ See tooling section of this catalog for complete tool and die listings.

\* Use PUADP-1 adaptor with U -dies in Y46 HYPRESS™.

\*\* P-RT die sets for use in Y46 HYPRESS™ only, PUADP-1 adaptor not required.

\*\*\* The MM<sup>2</sup> conductor sizes listed are the recommendations for Class 2 conductor.

Available undrilled. Add suffix U to catalog number (example: YA25U).

◆ For applications greater than 2000 Volts consult cable manufacturer for voltage stress relief instructions.

Note: All dimensions shown are for reference only.

Blue highlighted items are industry standard and most frequently ordered.